

GB60

Bayonet connector for press-in contacts with an extended Insert for better insulation at increased voltage and with 1 guiding Key These connectors correspond to the standards MIL-DTL-5015 and VG95234 for increased voltage. They can be used for both indoor and outdoor applications. They have an extended elastic insert for better insulation. These connectors are only available in size 24 and 40.

Depending on the backshell used watertightness of up to IP69K can be achieved for the connection. The connectors have been tested for outdoor use according to IEC EN 60529 IP65 / IP67 / IP68 (5bar) and according to DIN 40050 and IP69K.

For outdoor applications rubber coated bayonet rings with dust protection lips are recommended. In addition a back shell with sealed cable clamp or with an adapter for heat shrinkable shapes is required.

The main properties of these railway-fit connectors are, in brief: Bayonet coupling | Only inserts with layout 24-A4, 40-A3 and 40-A16 available | Resistant against fuels, greas- and insulating oils etc. | High mechanical loading capacity

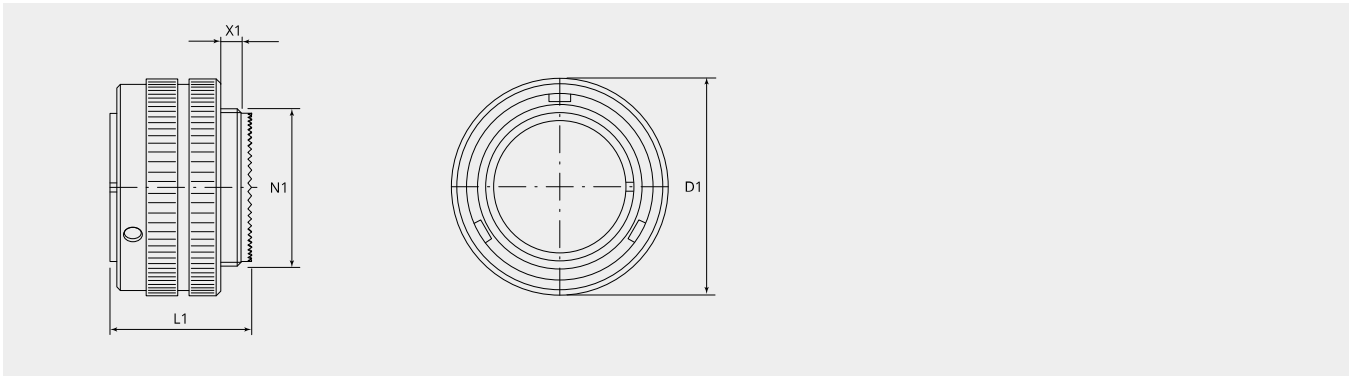

Item number	Size	Number of contacts	D1 (Ø)	N1	L1 (mm)
GB60-40-A4SN-SAC	40	4	73.0	2 5/16"-16 UN 2A	60.0