



Contacts

Socket contact size 0*, 16mm²

Item number: 10-905-0-162G62

Mechanical properties contacts

Contact type:	Socket with lamellas for increased current transfer
Strand/wire adaptation:	Crimp
Contact Material:	CU alloy
Protective layer:	silver plated, 3.5µm
Wire section (mm²):	16
Stripping length (mm):	17

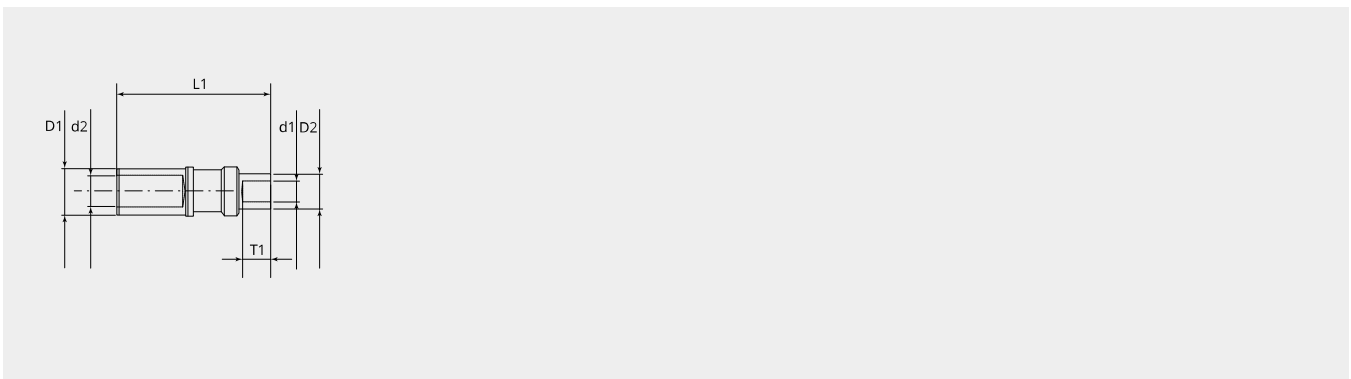

Dimensional drawing

D1 (Ø):	15.0
D2 (Ø):	9.3
d1 (Ø):	6.2
d2 (Ø):	9.3
L1 (mm):	50
T1 (mm):	16

Electrical properties contacts

Nominal current (A):	200
Maximal current (A):	300
Test current (A):	240