



SUB-D contacts

Machined contact pins

Item number: SUMCP24-28AU1

Packing unit: 100

Mechanical properties contacts

Contact type:	Pin
Strand/wire adaptation:	Crimp
Number of mating cycles (min.):	500
Contact Material:	CU alloy
Protective layer:	Gold plated, 1.3µm over 2.0µm Ni
Wire section (mm ²):	0.08 - 0.20
Wire section (AWG):	28 - 24

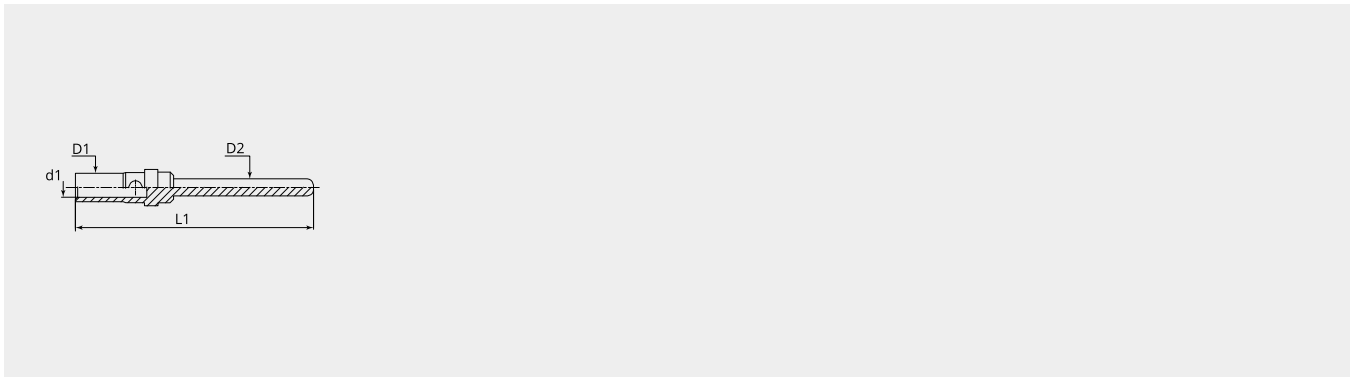

Dimensional drawing

D1 (Ø):	1.7
D2 (Ø):	1.0
d1 (Ø):	0.6
L1 (mm):	14.0