



Contacts

Pin contact K70C series, 70A, 25mm²

Item number: GMRC-PK70C-25AG

Packing unit: 5

Mechanical properties contacts

Contact type:	Pin
Strand/wire adaptation:	Crimp
Number of mating cycles (min.):	500
Contact Material:	CU alloy
Protective layer:	silver plated
Wire section (mm²):	25
Stripping length (mm):	15
Max. Cable insulation Ø (mm):	11

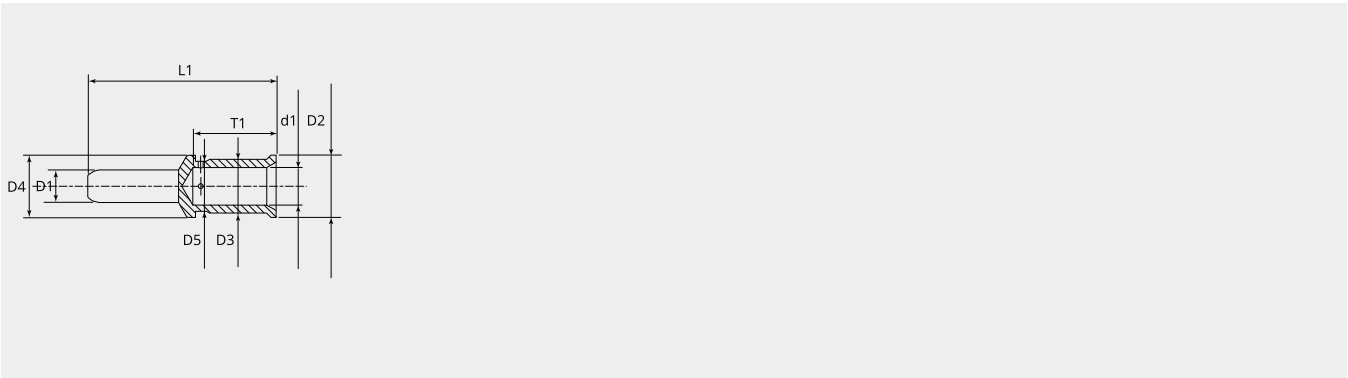

Dimensional drawing

D1 (Ø):	6.0
D2 (Ø):	11.5
D3 (Ø):	10.0
D4 (Ø):	11.5
d1 (Ø):	7.0
L1 (mm):	35.0
T1 (mm):	15.5

Electrical properties contacts

Nominal current (A): 70