



Contacts

Pin contact KC series, 100A, 10mm²

Item number: GMRC-PKC-10AG

Packing unit: 5

Mechanical properties contacts

Contact type:	Pin
Strand/wire adaptation:	Crimp
Number of mating cycles (min.):	500
Contact Material:	CU alloy
Protective layer:	silver plated
Wire section (mm ²):	10
Stripping length (mm):	19

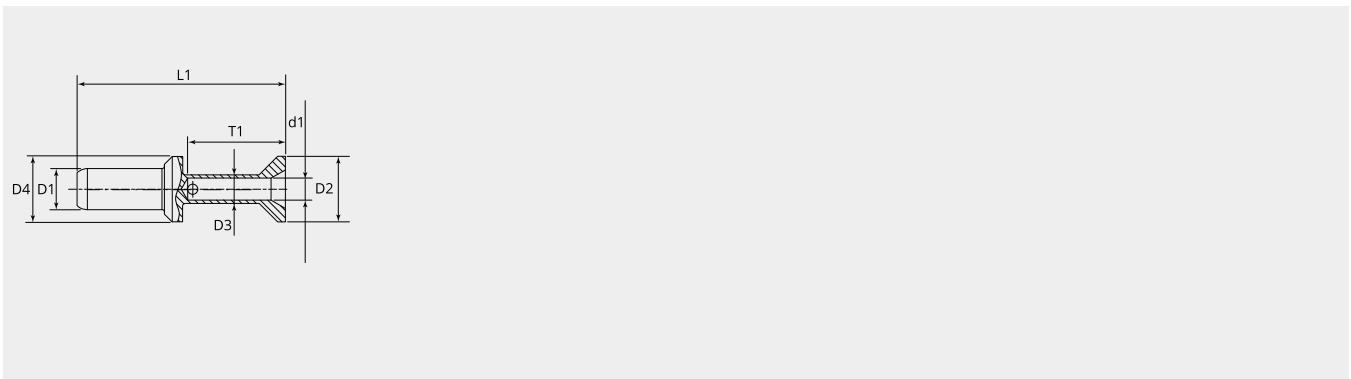

Dimensional drawing

D1 (Ø):	8.0
D2 (Ø):	12.7
D3 (Ø):	5.6
D4 (Ø):	12.7
d1 (Ø):	4.3
L1 (mm):	40.5
T1 (mm):	19.0

Electrical properties contacts

Nominal current (A):	100
----------------------	-----

