

# Contacts

Socket contact HC series, 200A, 35mm<sup>2</sup>

Item number: GMRC-SHC-35AG

Packing unit: 1

## Mechanical properties contacts

<b>Contact type:</b>	Socket
<b>Strand/wire adaptation:</b>	Crimp
<b>Number of mating cycles (min.):</b>	500
<b>Contact Material:</b>	CU alloy
<b>Protective layer:</b>	silver plated
<b>Wire section (mm<sup>2</sup>):</b>	35
<b>Stripping length (mm):</b>	22.5
<b>Max. Cable insulation Ø (mm):</b>	18

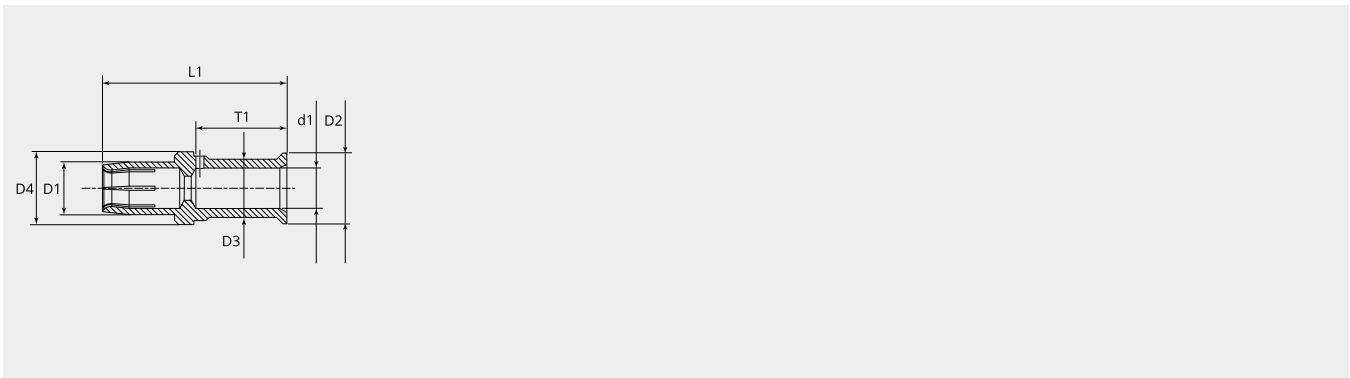

## Dimensional drawing

<b>D1 (Ø):</b>	13.0
<b>D2 (Ø):</b>	17.5
<b>D3 (Ø):</b>	12.5
<b>D4 (Ø):</b>	18.0
<b>d1 (Ø):</b>	8.2
<b>L1 (mm):</b>	45.6
<b>T1 (mm):</b>	22.5

## Electrical properties contacts

**Nominal current (A):** 200