



# Contacts

Socket contact KC series, 100A, 25mm<sup>2</sup>

Item number: GMRC-SKC-25AG

Packing unit: 5

## Mechanical properties contacts

Contact type:	Socket
Strand/wire adaptation:	Crimp
Number of mating cycles (min.):	500
Contact Material:	CU alloy
Protective layer:	silver plated
Wire section (mm <sup>2</sup> ):	25
Stripping length (mm):	19

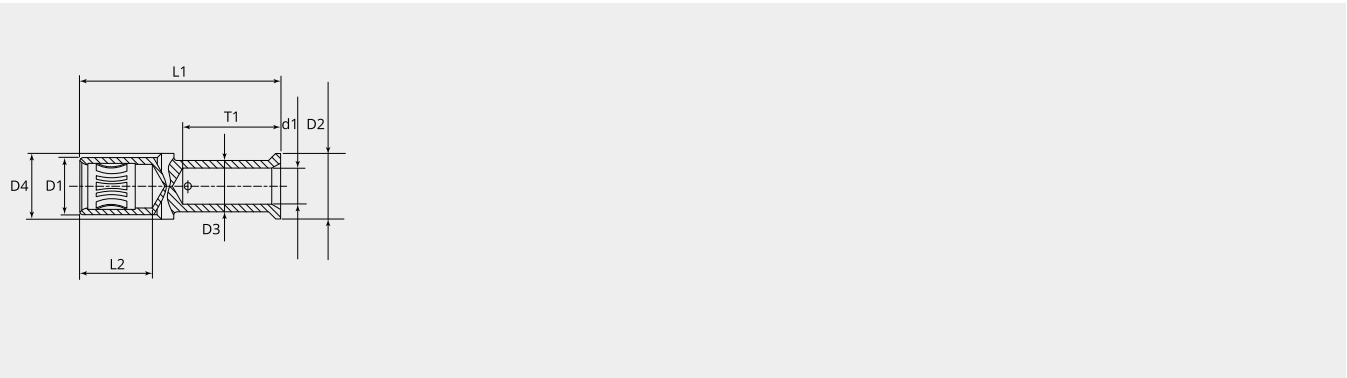

## Dimensional drawing

<b>D1 (Ø):</b>	11.0
<b>D2 (Ø):</b>	12.7
<b>D3 (Ø):</b>	10.0
<b>D4 (Ø):</b>	12.7
<b>d1 (Ø):</b>	7.0
<b>L1 (mm):</b>	39.0
<b>L2 (mm):</b>	14.2
<b>T1 (mm):</b>	19.0

## Electrical properties contacts

**Nominal current (A):** 100