



# Contacts

Pin contact HC series, 650A, 120m<sup>2</sup>

Item number: GMRC-PHC650-120AG

Packing unit: 1

## Mechanical properties contacts

|                                  |               |
|----------------------------------|---------------|
| Contact type:                    | Pin           |
| Strand/wire adaptation:          | Crimp         |
| Number of mating cycles (min.):  | 500           |
| Contact Material:                | CU alloy      |
| Protective layer:                | silver plated |
| Wire section (mm <sup>2</sup> ): | 120           |
| Stripping length (mm):           | 42.0          |

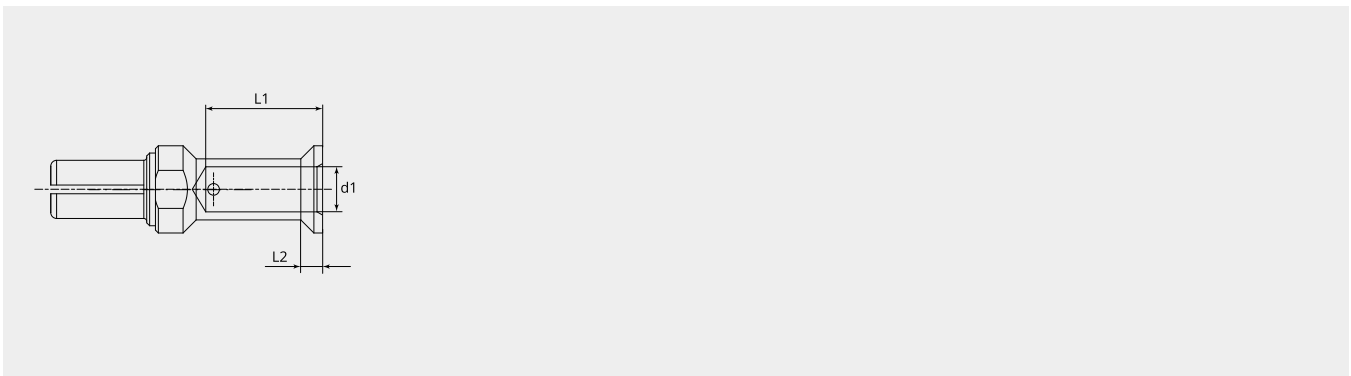

## Dimensional drawing

|          |      |
|----------|------|
| d1 (Ø):  | 15.5 |
| L1 (mm): | 40.0 |
| L2 (mm): | 10.0 |

## Electrical properties contacts

|                      |     |
|----------------------|-----|
| Nominal current (A): | 650 |
|----------------------|-----|

