



# Contacts

Pin contact HC series, 650A, 150m<sup>2</sup>

Item number: GMRC-PHC650-150AG

Packing unit: 1

## Mechanical properties contacts

Contact type:	Pin
Strand/wire adaptation:	Crimp
Number of mating cycles (min.):	500
Contact Material:	CU alloy
Protective layer:	silver plated
Wire section (mm <sup>2</sup> ):	150
Stripping length (mm):	42.0

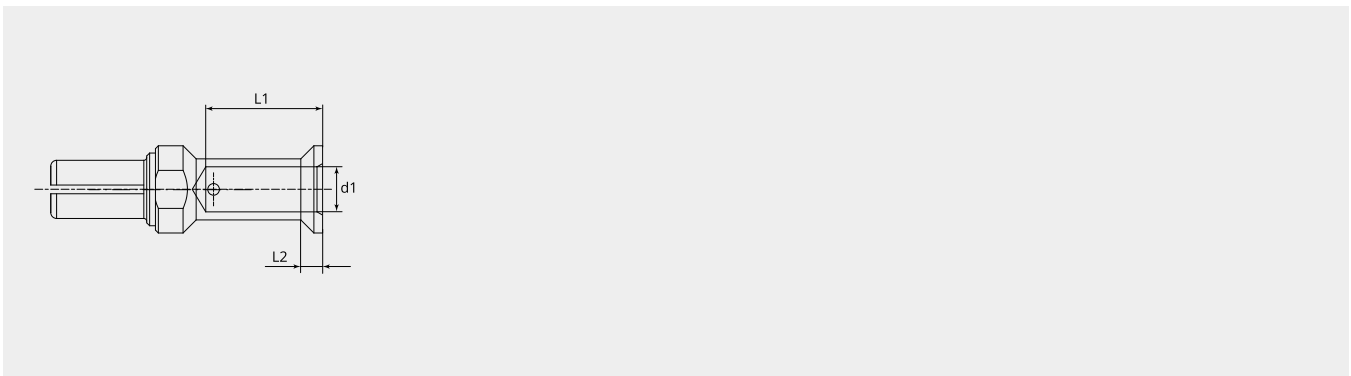

## Dimensional drawing

d1 (Ø):	17.0
L1 (mm):	40.0
L2 (mm):	10.0

## Electrical properties contacts

Nominal current (A):	650
----------------------	-----



## Complementary products:

### Counterpart:



**GMRC-SHC650-120AG**

Contacts



**GMRC-SHC650-150AG**

Contacts



**GMRC-SHC650-185AG**

Contacts



**GMRC-SHC650-240AG**

Contacts



**GMRC-SHC650-95AG**

Contacts