



Contacts

Pin contact HC series, 650A, 240m²

Item number: GMRC-PHC650-240AG

Packing unit: 1

Mechanical properties contacts

Contact type:	Pin
Strand/wire adaptation:	Crimp
Number of mating cycles (min.):	500
Contact Material:	CU alloy
Protective layer:	silver plated
Wire section (mm ²):	240
Stripping length (mm):	46.0

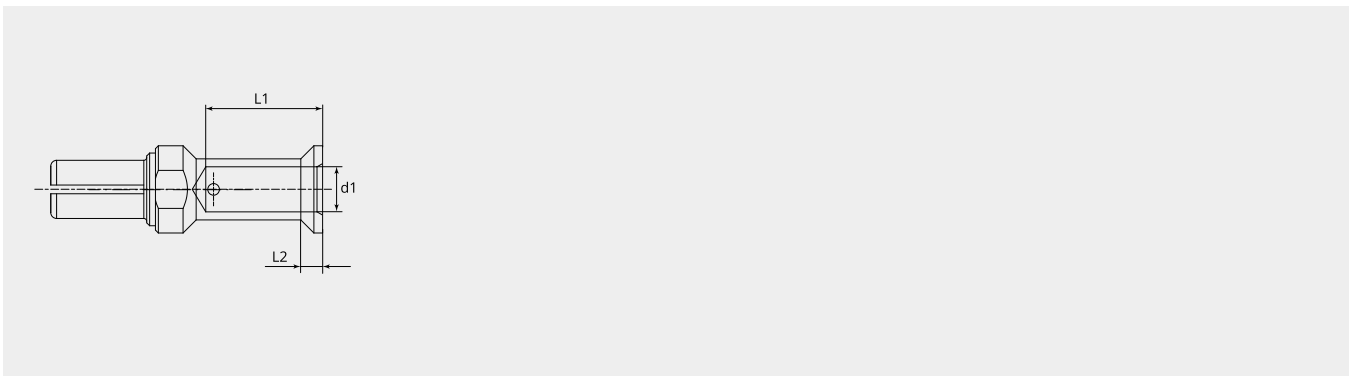

Dimensional drawing

d1 (Ø):	22.5
L1 (mm):	31.0
L2 (mm):	7.0

Electrical properties contacts

Nominal current (A):	650
----------------------	-----



Complementary products:

Counterpart:



GMRC-SHC650-120AG

Contacts



GMRC-SHC650-150AG

Contacts



GMRC-SHC650-185AG

Contacts



GMRC-SHC650-240AG

Contacts



GMRC-SHC650-95AG

Contacts