



Contacts

Pin contact HC series, 650A, 95m²

Item number: GMRC-PHC650-95AG

Packing unit: 1

Mechanical properties contacts

| | |
|----------------------------------|---------------|
| Contact type: | Pin |
| Strand/wire adaptation: | Crimp |
| Number of mating cycles (min.): | 500 |
| Contact Material: | CU alloy |
| Protective layer: | silver plated |
| Wire section (mm ²): | 95 |
| Stripping length (mm): | 42.0 |

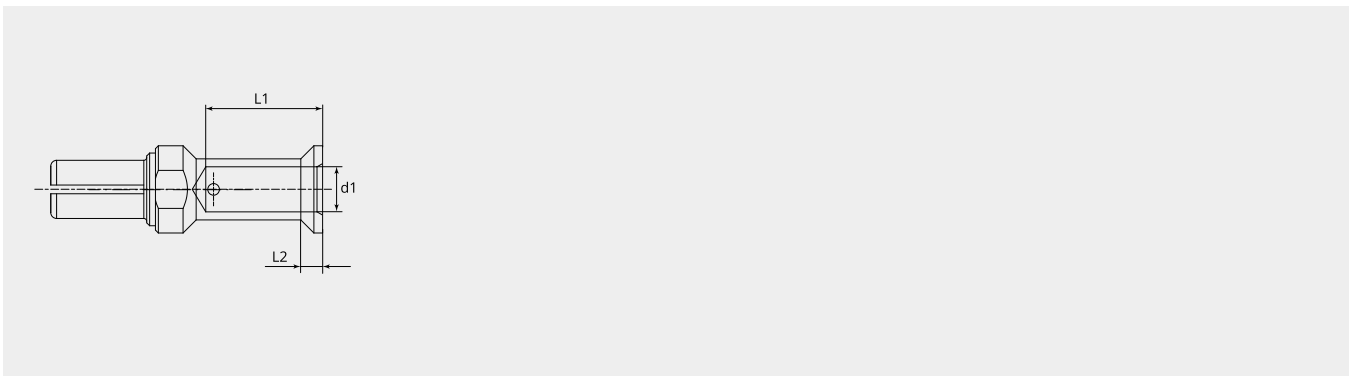

Dimensional drawing

| | |
|----------|------|
| d1 (Ø): | 13.5 |
| L1 (mm): | 40.0 |
| L2 (mm): | 10.0 |

Electrical properties contacts

| | |
|----------------------|-----|
| Nominal current (A): | 650 |
|----------------------|-----|



Complementary products:

Counterpart:



GMRC-SHC650-120AG

Contacts



GMRC-SHC650-150AG

Contacts



GMRC-SHC650-185AG

Contacts



GMRC-SHC650-240AG

Contacts



GMRC-SHC650-95AG

Contacts