



Contacts

Socket contact HC series, 650A, 120mm²

Item number: GMRC-SHC650-120AG

Packing unit: 1

Mechanical properties contacts

Contact type:	Socket
Strand/wire adaptation:	Crimp
Number of mating cycles (min.):	500
Contact Material:	CU alloy
Protective layer:	silver plated
Wire section (mm ²):	120
Stripping length (mm):	42.0

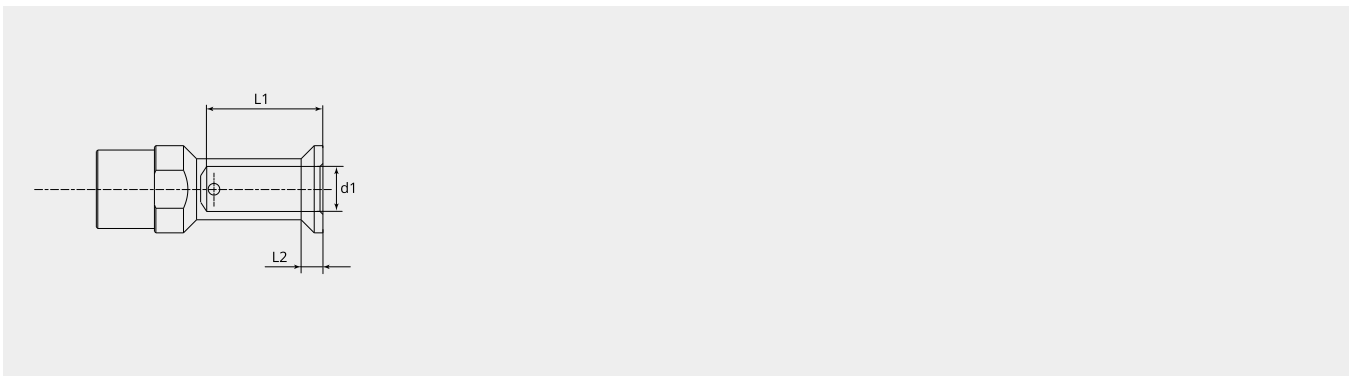

Dimensional drawing

d1 (Ø):	15.5
L1 (mm):	40.0
L2 (mm):	10.0

Electrical properties contacts

Nominal current (A):	650
----------------------	-----

